



## OWNER'S MANUAL

READ ALL INSTRUCTIONS  
CAREFULLY BEFORE  
INSTALLING OR USING THIS  
COVER.

**INSTALLER:** These instructions and warranty card must be given to the consumer.

**CONSUMER:** Retain these instructions for future use.

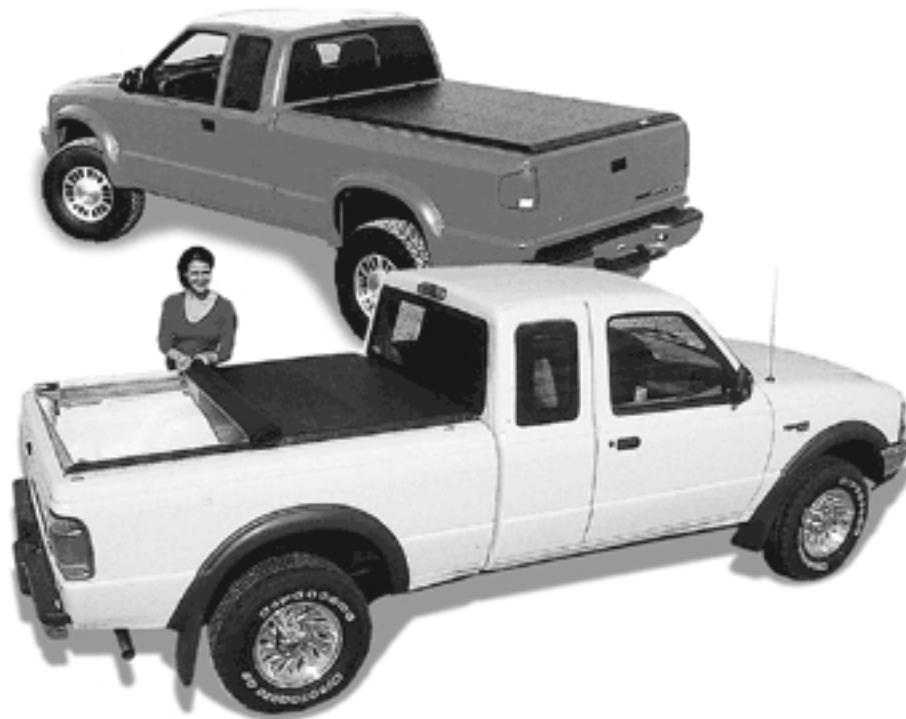



## CONTENTS

■ PARTS LIST AND DESCRIPTION . . . . . 1	■ SAFETY INFORMATION . . . . . 5
■ INSTALLATION INSTRUCTIONS . . . . . 2-4	■ TROUBLE SHOOTING . . . . . 6
■ OPERATING INSTRUCTIONS . . . . . 5	■ WARRANTY . . . . . 7
■ INSPECTION AND MAINTENANCE . . . . . 5	

### FOR YOUR RECORDS:

DATE PURCHASED \_\_\_\_\_

WHERE PURCHASED \_\_\_\_\_

SERIAL NUMBER \_\_\_\_\_

If you find a part, or parts missing or defective, or if you're having trouble installing your new pickup cover, call our toll-free number on the back page. **It is recommended that you take the time to review all the material in this manual, even if already familiar with the product, because often changes are made without prior notice.**

KEY NO.	PART NO.	DESCRIPTION
1	LRP-01	Left Rail (Drivers Side)
2	LRP-02	Right Rail
3	LRP-03	Rear Roll-Up Bar
4	LRP-04	Front Bar
5	LRP-05	Front Bar Clamp w/Bolt and Washer
7	LRP-06	Support Bows (3 Per Cover) (2 On Some Short Boxes)
8	LRP-07	Cover Assy.
9	LRP-08	Rail Clamps w/Bolts
12	LRP-10-N	Nylon Latch
13	LRP-37	Nylon Strikes (Hidden On View) With Molded in Bolt and Nut (2 Per Cover)
14	LRP-17	Quick Release Safety Strap (1 Per Cover)
15	LRP-36	Slide Lock (2 Per Cover)
		Owners Manual

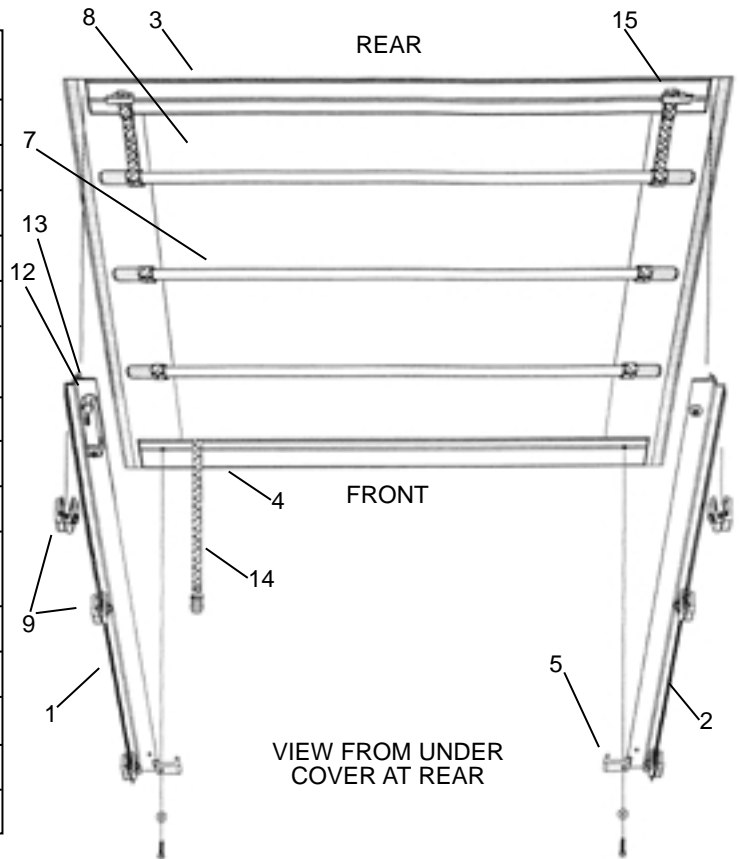

**PARTS LIST**

**PARTS DIAGRAM**

# INSTALLATION INSTRUCTIONS

## TOOLS & EQUIPMENT NEEDED

- A. Two 9/16" box wrenches
- B. One 1/2" box wrench
- C. Impact wrench with 9/16" socket
- D. Household weigh scale (for adjusting cover tension)
- E. Two vise-grip type C-clamps (for holding rail to pickup box)
- F. Protective eye wear

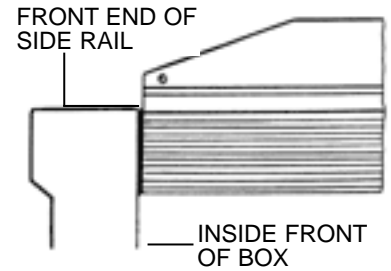

**ILLUSTRATION 1**

## STEP 1: POSITIONING THE SIDE RAILS

- A. Place the mounting portion of the rail against the upper inside wall of the box. Slide the rail forward until the front end stops against the inside front of the box. **(See Illustration 1 and 2)**. Use two vise-grip C-clamps to temporarily clamp the rail to the box. Setting of vise-grip clamp should be only snug tight.

### INSTALLATION TIP:

**The front end of the rail is the end without the nylon strike bracket.**

- B. Adjust the height of the rail by positioning the edge of the rail flush with or slightly higher than the top of the box. **(See Illustration 2)**.
- C. At the tailgate end, adjust the edge of the side rail even with the top of the tailgate or tailgate protector. **(See Illustration 3)**. (Example: if tailgate protector is 1/8 inch thick, raise the rear of the rail 1/8 inch).

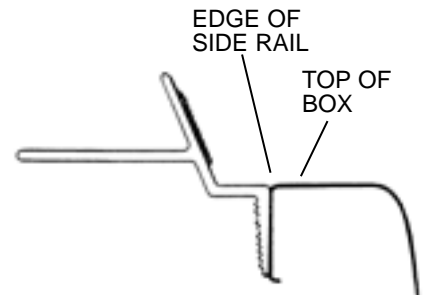

**ILLUSTRATION 2**

COVER IS TOO WIDE...	...CHECK RAILS. RAILS IN - TOO WIDE - PUSH ALL CLAMPS TO TOP OF RAIL.
TOO NARROW...	RAILS OUT - TOO NARROW - PULL ALL CLAMPS DOWN 1/2 WAY ON RAIL. (Refer to Step 2)
LOPSIDED COVER TOO MUCH ON ONE SIDE...	...CHECK FRONT BAR. IT MUST BE CENTERED SIDE TO SIDE.
TOP OF TAILGATE HITS REAR BAR WHEN ATTEMPTING TO CLOSE...	...RAISE SIDE RAILS AT REAR OF BOX UNTIL TAILGATE CLOSES WITHOUT PUSHING REAR BAR UP. (Refer to Step 2 and Step 5)
NYLON LATCH DOESN'T ENGAGE...	...COVER TOO LOOSE. FIRST SET PROPER COVER TENSION. (Step 4 and 5) ...AND/OR REAR OF RAILS ARE TOO LOW, ADJUST REAR OF RAILS UP.

### NOTE:

We have been pre-adjusting nylon latches...so front bar needs to be right (tight enough) for latch to work properly, and rear of rails need to be adjusted up properly.

# INSTALLATION INSTRUCTIONS

## STEP 3: MOUNTING THE COVER

- A. Remove cover from plastic wrapping. Leave cover rolled up as the outer bar goes to the front of the box. There are two nuts in the front bar channel. Use these to attach the front bar clamps by inserting bolt through washer and clamp, then turn bolt into nut in channel, but leave loose for now.

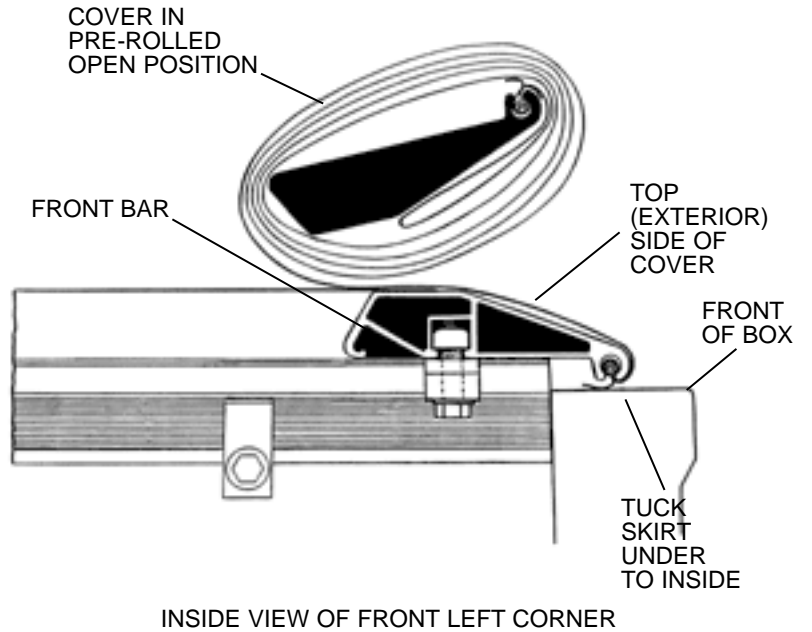

ILLUSTRATION 4

- B. Place the front bar (with cover rolled up) on the front flat portion of the side rails. Align the front edge of the bar so that it covers about half of the front box rail. (See *Illustration 4*). This is the starting point before fine adjustments are made. Center the edges of the front bar between the side rails. Slide the tooth end of the clamps under the rail until stopped by the bolt. Tighten clamps with 9/16 inch wrench. (See *Illustrations 4 and 5*).

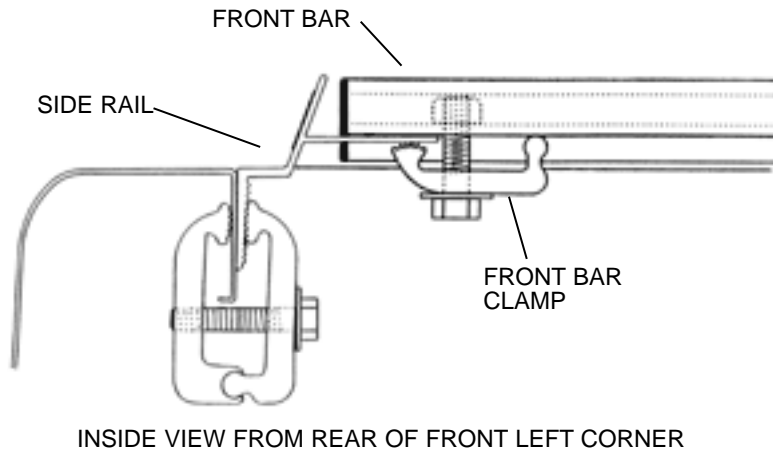

ILLUSTRATION 5

# INSTALLATION INSTRUCTIONS

## STEP 3: CONTINUED

- C. Roll cover out to rear and engage roll bar in the strikes. Press down on bar to close cover. Recommended downward pressure on roll bar is 30 lbs. To adjust cover tension, loosen front clamps and slide front bar forward (tighten) or rearward (loosen) and tighten clamps. The pounds of pressure can be measured by standing on a scale while pushing slowly downward on rear roll bar. (*See Illustration 6*). After the cover has been properly tensioned, inspect the front clamps to make sure they are tight and the front bar is secured.

### INSTALLATION TIP:

When fine tuning cover tension, slide front bar about 1/16 inch at a time. Make pencil marks on rail in line with rear bar to monitor your adjustments.

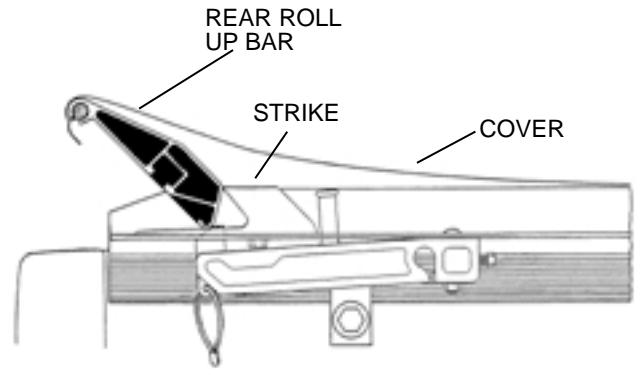

INSIDE VIEW OF REAR LEFT CORNER

ILLUSTRATION 6

### INSTALLATION TIP:

Place a household weigh scale at rear of box on floor. Stand on scale and read weight. Slowly push down on rear roll bar till closed and read the lowest reading on scale. Subtract this number from the first reading. The net difference is the amount of pounds needed to close rear roll bar. Adjust cover tension to a recommended 30 lbs.

## STEP 4: TESTING OPERATION OF LATCH AND TAILGATE

- A. First test the height at the rear of the side rails. With tailgate open and cover closed, close tailgate. Does tailgate raise or push up on the rear of the roll bar? If yes, raise up the rear of the side rails. This must be done so tailgate does not interfere with latching mechanism.
- B. The latch is located near the rear of the left side rail. With the cover closed and tailgate open, the latch should lock in inside edge of roll bar. To test, lift up on roll bar without depressing latch. Cover will not open. (*See Illustration 7*).
- C. Next, test latch with tailgate closed and cover open. Close the cover. Does tailgate prevent latch from engaging in roll up bar? To determine, try opening rear bar without depressing latch button. If cover opens, latch is not engaging. This means the rear of the side rails must be raised up until tailgate clears rear bar. (*See Illustration 7*).
- D. After all adjustments are complete, with the cover closed, make sure the self forming seal is tucked inside. Do this by closing the tailgate. Leave the tailgate and cover closed to set the self forming seal. (*See Illustration 7*).

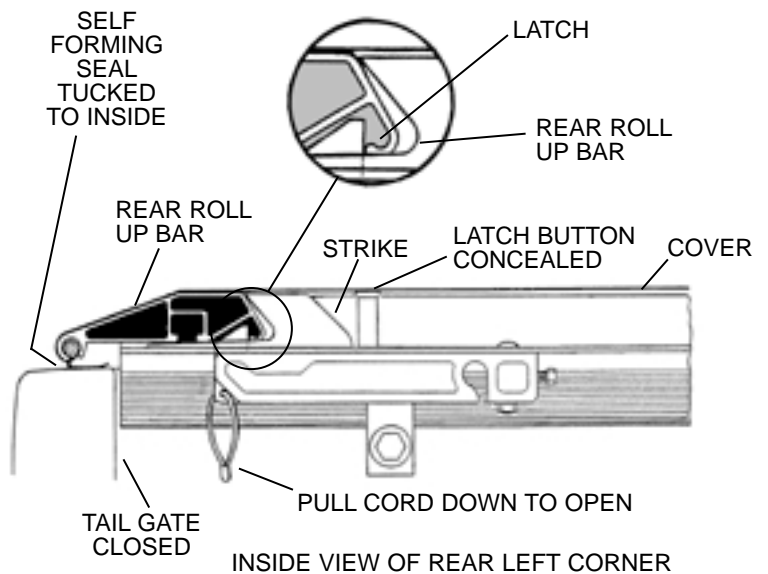

INSIDE VIEW OF REAR LEFT CORNER

ILLUSTRATION 7

# OPERATING INSTRUCTIONS



Unroll to close. Roll-up to open.



Push down to close. Depress latch button and lift to open.



Seal hook and loop system on sides to close. Auto-releases when opening.

## STEP 1: CLOSING FROM OPEN POSITION

- Release the retainer strap at the front and using both hands roll the cover out to the rear of box.
- Position the roll-up bar against the strikes. Push down on the rear of the bar to close the cover.
- Finally, from the side of the box seal the edges with the hook and loop sealing system.

## STEP 2: OPENING FROM CLOSED POSITION

- Push down on the cover directly above the concealed button to release the latch, while holding button down lift up on the rear of the roll-up bar to open the cover, or open tailgate and pull down on cord.
- Using both hands, roll the cover up toward the front of the box (not against cab.)
- Finally, securely fasten the retainer strap to store the cover.

**SAFETY WARNINGS:** ALWAYS FINISH SECURING THE COVER.

DO NOT OPERATE COVER IN WINDY CONDITIONS.



The LITERIDER COVER is equipped with a manual slide lock located under the roll-up bar on both sides. See item number 15 in the parts diagram on page 1. With the cover closed and the tailgate open, push the slide lock against the side rail until it hooks under the rail. To unlock the rear bar, slide the lock away from rail until it clears. For added security lock tailgate. If your pickup is not equipped with a tailgate lock, call AGRI-COVER, INC. for information and availability on optional tailgate locks.



Cover rolled fully open with safety strap secured. **NOTE:** Cover is not rolled against cab to avoid wear on paint and cover.

# INSPECTION AND MAINTENANCE

- Inspection and much of the maintenance can be done by the operator. It may be necessary to review the installation and operating instructions.
- Periodically inspect the cover assembly. Check for loose bolts and parts and the condition of all parts. Test the operation to ensure that the parts are functioning properly and that the cover is in top operational condition.
- If nylon latch has been damaged replace with new one.

**NOTE:** Inspection and/or maintenance should also be performed anytime a malfunction is observed or suspected.

If you need assistance inspecting and/or servicing your cover, or if you want to order a replacement part, call our toll-free number on the back page.

- Vinyl cover can be treated with vinyl protectants. Avoid silicon base products.
- Never clean cover with petroleum or citrus base products. Use mild soap and water.

# SAFETY INFORMATION

- Do not cover cargo that is higher than the cover.
- Do not place object on or against the cover or its framework at any time.
- Always secure cargo so cargo can not shift and damage the cover or its parts.
- Do not use the covers' framework to tie down cargo.
- Never stand, sit or ride on the cover or allow others to do so.
- Do not leave valuables in an unattended vehicle as the cover does not prevent theft of contents in the truck box.
- The cover does not eliminate moisture and dust from entering the truck box. Special wrapping or packaging of the contents may be necessary.
- Due to poor ventilation, if you allow a pet animal in the box, leave cover open. Do not allow people or animals to occupy box with the cover closed.
- When towing vehicle backwards, cover must be rolled fully open and secured with safety strap or fully closed and secured with manual slide lock.

## LITERIDER TROUBLESHOOTING

---

<b>PROBLEM</b>	<b>SOLUTION</b>
COVER TOO LOOSE...	...TURN BOTH TENSION ADJUSTERS COUNTER CLOCKWISE TO MOVE FRONT BAR FORWARD. (Refer to Step 4)
COVER TOO TIGHT...	...TURN BOTH TENSION ADJUSTERS CLOCKWISE TO MOVE FRONT BAR REARWARD. (Refer to Step 4)
GAP BETWEEN ROLL-UP BAR AND TAILGATE...	...NYLON LATCH TOO LOOSE, TIGHTEN LATCH. (Refer to Step 5)
LIFT COVER OPEN W/OUT PUSHING NYLON LATCH...	...NYLON LATCH TOO TIGHT, LOOSEN LATCH. (Refer to Step 5)

# MANUFACTURER'S LIMITED WARRANTY

---

Agri-Cover, Inc. extends the following limited warranty on its Roll-Up Covers to the original retail purchaser:

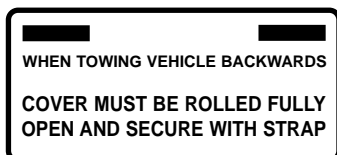

Agri-Cover, Inc. warrants its LITERIDER roll-up cover to be free from defects in material and workmanship under normal use for one (1) year from date of purchase.

ANY IMPLIED WARRANTY APPLICABLE TO THE ROLL-UP COVER IS LIMITED IN DURATION

TO ONE YEAR FROM THE DATE OF PURCHASE. Agri-Cover's sole obligation under this warranty or any implied warranty is limited to the repair or replacement at its option, of defective parts only. No labor or service allowance is given or implied. IN NO EVENT SHALL AGRI-COVER, INC. BE LIABLE FOR INCIDENTAL, CONSEQUENTIAL, OR SPECIAL DAMAGES. Some states do not allow limitations on how long an implied warranty lasts or exclusions of incidental or consequential damages, so the above limitations and exclusions may not apply to you.

This warranty does not cover any failure due to abuse, misuse, alteration, neglect, improper assembly or installation, or improper maintenance.

This warranty gives you specific legal rights and you may have other rights which vary from state to state.

Agri-Cover, Inc.  
Customer Service Dept.  
Hwy. 281 N.  
PO Box 508  
Jamestown, ND 58402  
Phone (800) 592-4459



LITERIDER is a trademark of AGRI-COVER, INC.  
U.S. Patent Nos. 5,076,338; 5,174,353; and other patents pending.